

WOOD GUARD RAIL REQUIRED
LEFT
 Sta. 636+34 to 636+58 Length 24 ft. ✓
RIGHT
 Sta. 636+34 to 636+58 Length 24 ft. ✓

NEW CULVERTS REQUIRED
 Sta. 636+40 - 30" Reinf. Concrete Pipe Culvert 32 Lin. ft. ✓
 Concrete Class B (1-2-4) 3.9 Cu. yds. ✓
 Reinforcing Steel 54 66 pounds. ✓

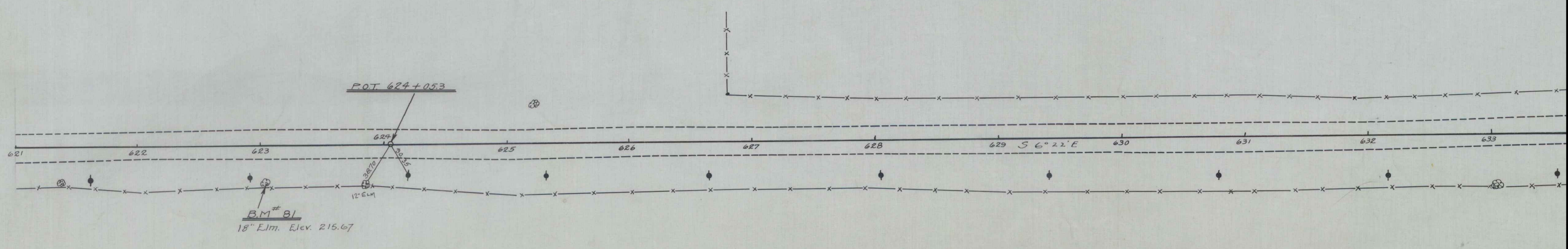

G. J. PHILLIPS

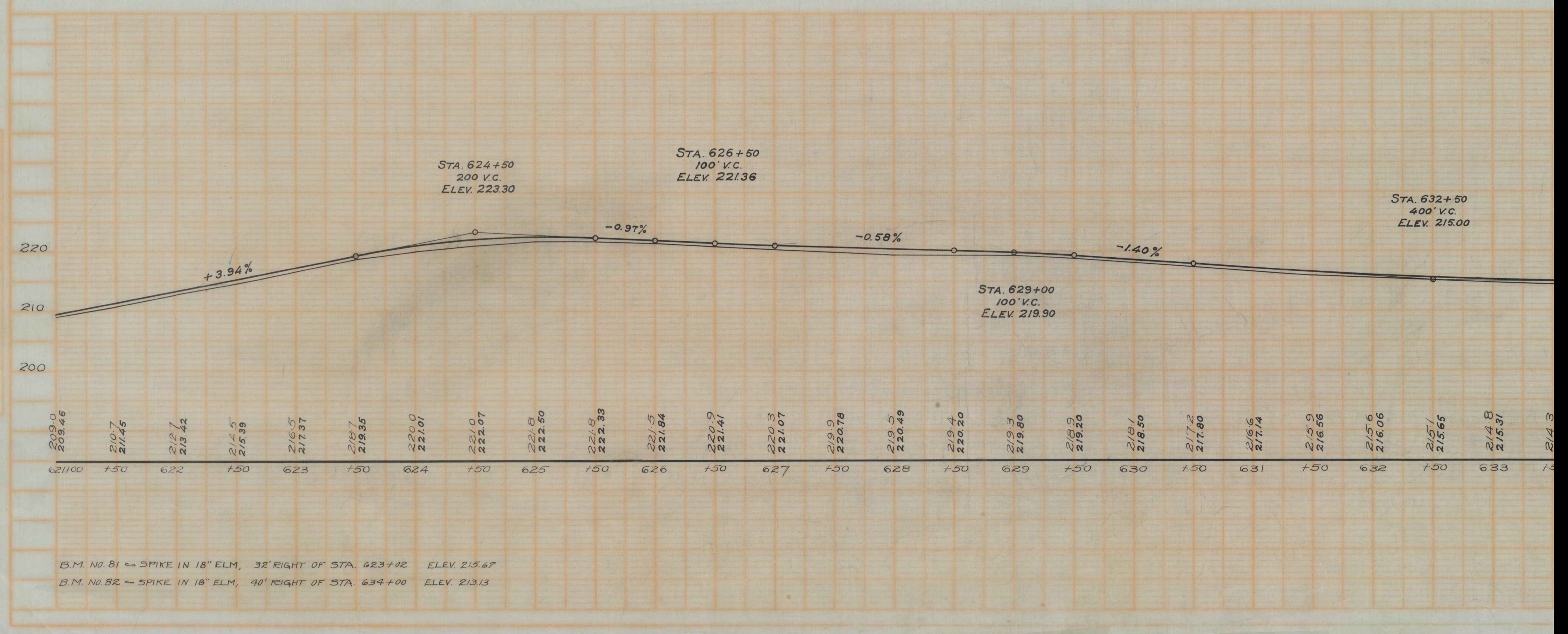

B.M. NO. 81 - SPIKE IN 18" ELM., 32' RIGHT OF STA. 623+00 ELEV. 215.67
 B.M. NO. 82 - SPIKE IN 18" ELM., 40' RIGHT OF STA. 634+00 ELEV. 213.13